

Air heater KW 2.0 5.0 Manual



Tips:

- 1). The fuel pipe should be 1.5 meter - 2 meters.
- 2). The voltage would be better, if 11.5 V - 12.8 volts.

---Articles and objects

---Blow hot air to container

Heater Safety instruction of installation and operation

- **Installation**

Prevent the substances around heater from being damaged and influenced by high temperature.

- **Exhaust emission system**

When put the exhaust vent, prevent the exhaust entering the heating space through ventilator, hot air inlet and window. Keep the exhaust pipe clear. The exhaust pipe outlet shall be kept away from anything flammable, and avoid heating and igniting the flammable goods and loading cargo on the ground.

- **The air inlet of combustion-supporting air**

The combustion-supporting air which is used for heater burning shall not be inhaled from passenger compartment. The air inlet shall not be blocked, and keep the inlet open and clear. If the air inlet equipped with filter, keep the filter clean regularly.

- **The heating air inlet**

The heater air shall be composed by fresh air or circulating air, which is inhaled from clean area. The air inlet pipe shall be protected by safety fence or other suitable tools, and keep the pipe clear and open.

- **The heating air outlet**

In order to prevent the people and goods from being damaged, the hot air pipe shall be installed in the place where it could not be accessed easily.

Safety instruction

- Following measures shall not be adopted
 - Change the important component of heater
 - Make use of the spare parts from other manufacturers without permission
 - Disobey the instruction and guide during installation or operation
- Only allow using original attachment and spare parts during installation and maintenance
- The heaters shall not be used in the places where may form flammable vapor or dust, for example:
 - Fuel depot
 - Carbon storehouse
 - Timber storehouse
 - Granary and similar sites
 - Diesel/petrol station
- The heaters shall be turned off when fill fuel
- If the fuel leak or discharge from the fuel system of heaters, please contact with the service provider to repair
- In the process of work, it is forbidden to cut off the electric

power directly to stop the heater working

Product

Survey

KW2.0 Air heater (hereinafter referred to as the heater) is independent to the original engine system, it makes use of 12V or 24V direct current to drive. There are two kinds of control mode of the heater: Automatic control mode and Manual control mode. The heater adopts light diesel and gasoline which corresponds to the environmental temperature as fuel, and it can be started and operated normally at the temperature of above -40°N . The inhaled fresh air is heated to hot air through heat exchanger by the energy which comes from fuel burning, then blown to where it is needed. This type of heater owns the advantage of compact structure, light weight, high thermal efficiency, economize on electricity and fuel, easy installation.

Technical specification

Power ZWH	2000	5000
Heating medium	Air	
Fuel	Diesel	
Fuelconsumption Z l/hH	0.12-0.24	0.18-0.48
Rated voltageZVH	12V / 24V	
Workingtemperature ZNH	-50NÍ 45N	
Weight ZKGH	3.6	5.2
DimensionZmmH	320x125x157	380x145x177

Structural principle

After the heater starts, the glow plug comes into operation, the magnetic pump begins to supply fuel, combustion-supporting fan inhales combustion-supporting air from outside of car. The fuel generates the heat by burning in combustion chamber, which is taken by aluminum heat exchanger. The inner air pushed by the heat exchange fan brings heat to where it is needed through the surface of heat exchanger. And the combustion emission is discharged through exhaust pipe.

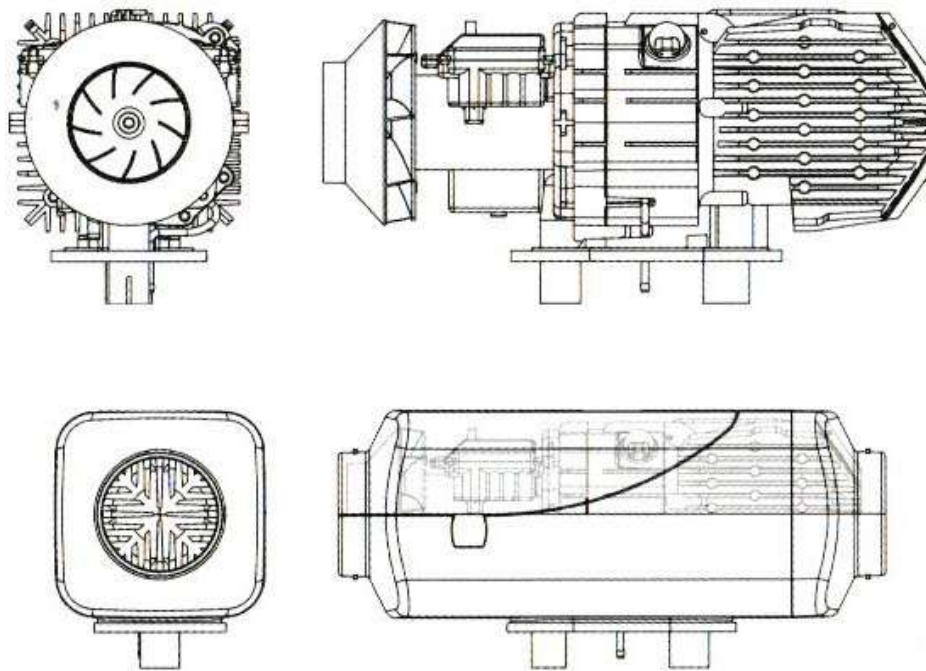

The structure of hood-shape case

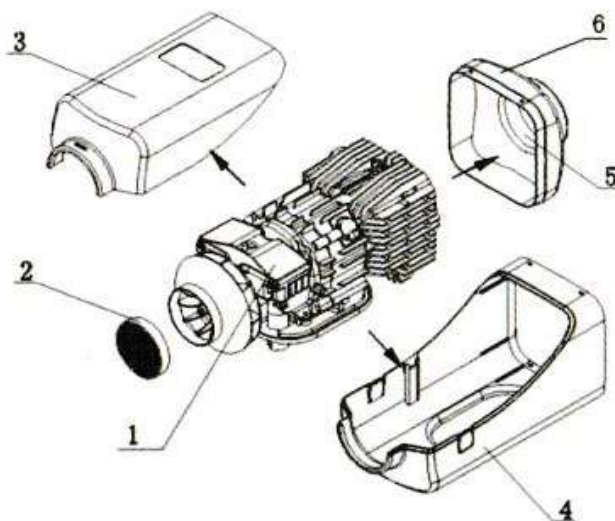

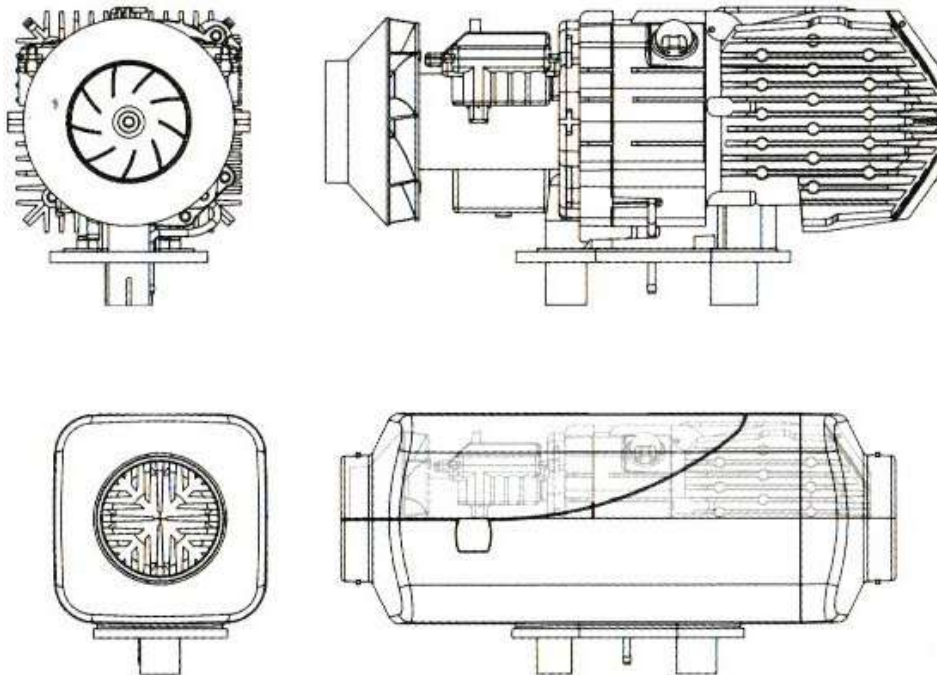

The structure of hood-shape case

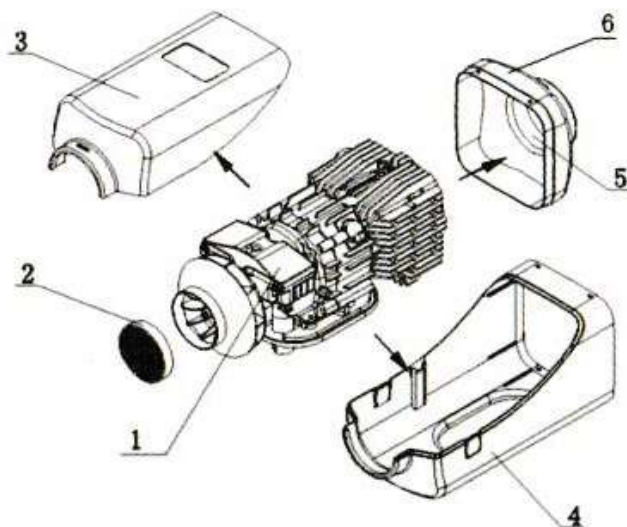

1-Main engine;2-Suction hood;3-Upper hood;4-Bottom-hood;
5-Air outlet; 6-Rear hood {Hood: Case/Shell}

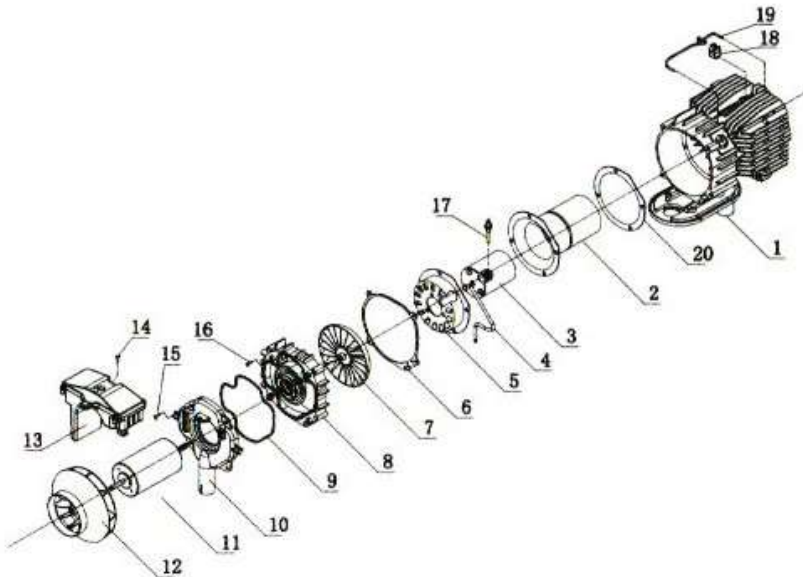

1.Exhaust tube 2.Combustion pipe3.Combustor4.Fuel tube 5.Air inlet
distributor6.Gasket7.Combustion supporting fan blades 8.Bracket of
fan motor 9.Gasket10.Combustion supporting air inlet11.Fan motor
12. Bladewheel of heating fan13.Main control panel 14.Fixing screw
15.Fixingscrew 16.Fixing screw17.ignitor 18. heat sensor
19. Sensor Fixed bracket

Installation

Only special-purpose parts can be used for installation of

the heater. Following picture is the diagram for installation. The positions and ways of fixing of various parts may vary from one automobile model to another, but the general principles must be followed in conformity with the requirements of this chapter. Otherwise the heater may not work normally or safety problems may occur.

Main heater installation

The main heater could be installed both inside and outside of the vehicle. If the heater is installed outside the vehicle, measures must be taken to avoid splashing water onto the heater. Enough space must be provided for installation for the convenience of heating air flow and installation, maintenance of the main heater.

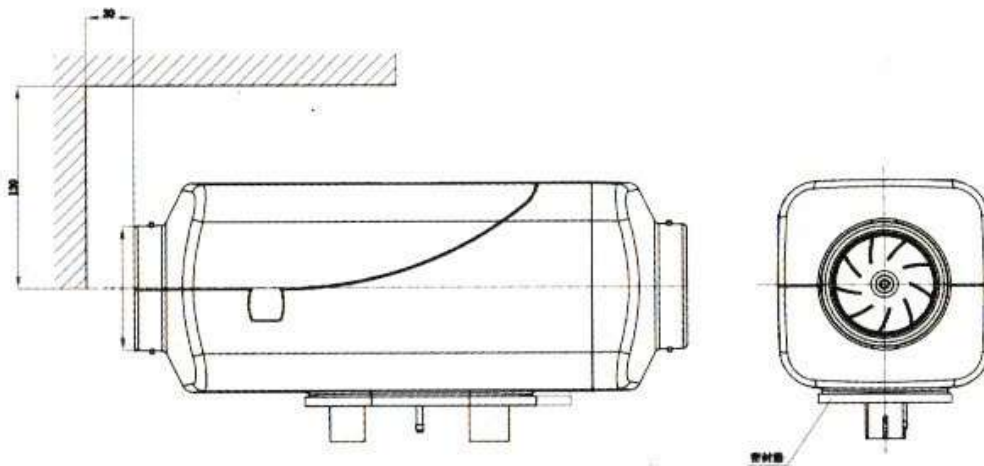

Good sealing is necessary between the main heater and the installation surface on the vehicle. The special gasket supplied by the manufacturer must be inserted in. And the installation surface must be even. Its parts at the installation

bases of the main heater should have unevenness less than 1mm. After drilling installation holes, evenness must be improved according to this requirement. At installation, please rotate the four M6 nuts tight, which are provided by the manufacturer.

For re-installation of the main heater, a new gasket must be used to replace the old one.

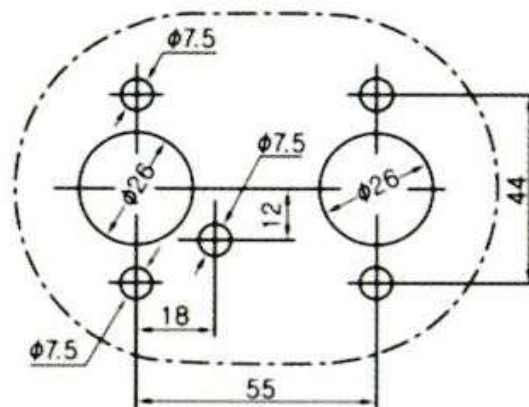

Attention must be paid to that the inclination angle shall not exceed the limit, or normal operation will be affected. Direction for installation of the main heater is shown in the following picture.

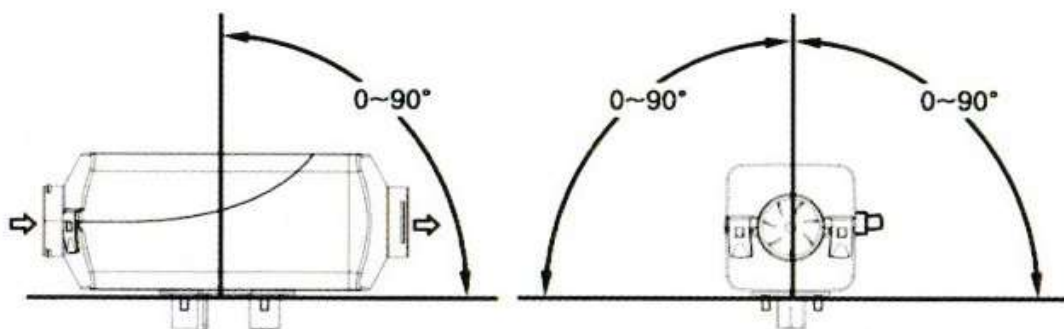

After installation of the main heater, please check and make sure that there is no contact or friction between the blade wheel of fan and other nearby parts to avoid unsmooth operation.

Installation of Air Heating System

The air heating system of the heater should not be connected with the air channel of the vehicle. Either independent outer circulation or inner circulation mode can be adopted.

When an external heating air tube is attached to the heater, the tube diameter should not be smaller than 85mm. Its material should be capable to resist temperature of 130°C.

The maximum pressure drop between the air inlet side and outlet side of the air heating system should not be higher than 0.15kPa.

The hot air from the heating system should not erupt onto such parts which are unable to resist heat. In passenger vehicles, the hot air vent should not be blocked by passengers. A self-provided protective net can be installed if necessary.

For heater working in external circulation mode, the position of air inlet port should be proper to guaranteed that under normal operation no splash of water can be sucked into the heater the no exhaust from the engine can be sucked in.

For heater working in internal circulation, measures should be taken to avoid re-entering of the supplied hot air into the air inlet port. If no air inlet tube is attached in this mode, an air inlet hood with grids must be installed at the air inlet port of the main heater. The inlet air should be drawn from the cold area of the compartment, such as under the seats or berths.

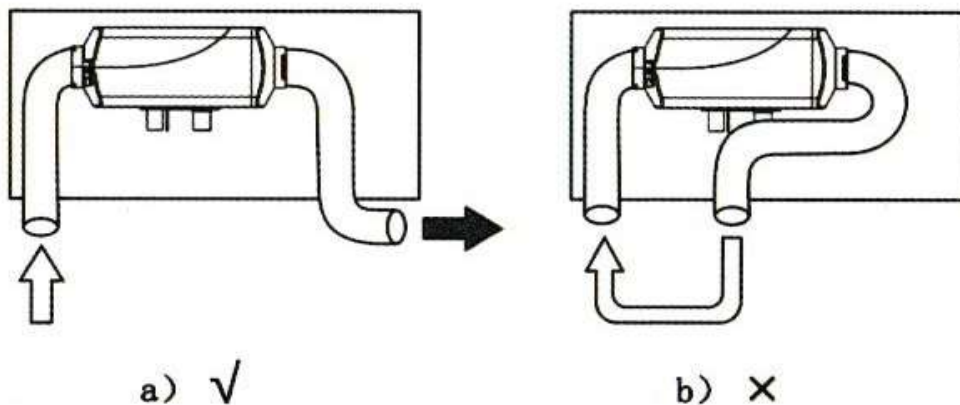

Installation of Fuel Supply System

Fuel for the heater can be supplied from the fuel tank of the vehicle or an additional independent fuel tank. It is not allowed to install the fuel tank in the cab or passenger compartment or any region that is possibly to cause fire if an independent fuel tank is used.

The elevation difference between the heater and fuel pump, and between the fuel pump and the fuel pump produces pressure from fuel to the fuel pump. The inner diameter and length of the fuel tube is related to the resistance of the fuel route. Please consider such factors for installation.

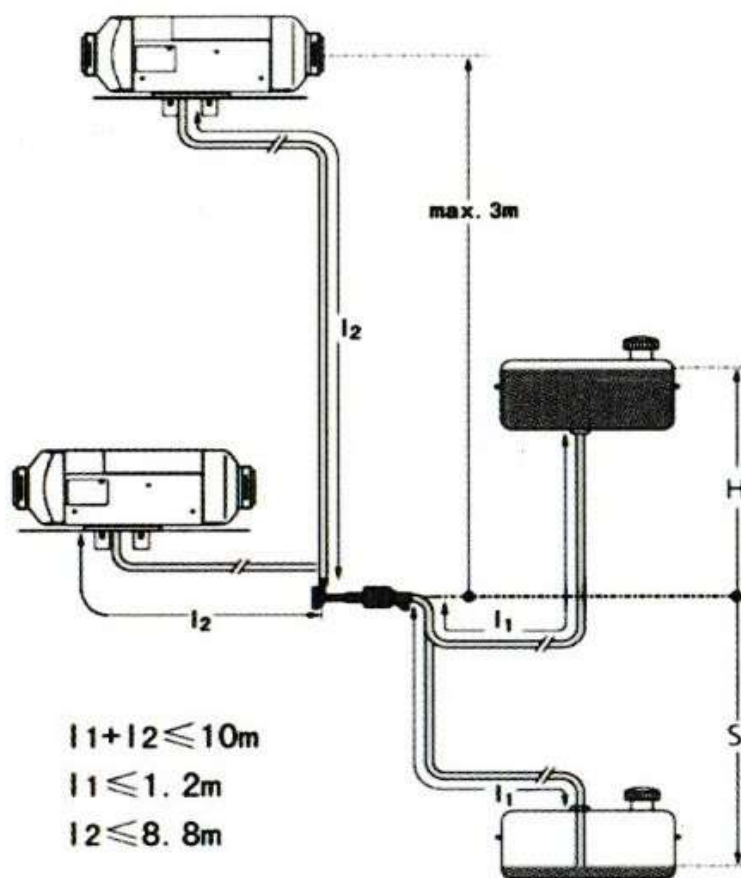

Fuel pump installation

The fuel pump should be installed in places that can avoid heat radiant from the vehicle parts that can emit heat and in places with cool air. Its ambient temperature should not exceed 20°C . Directions of installation of the fuel pump are shown in the following picture. When installing the fuel pump, please use the fuel pump holder supplied with the heater to hold the pump tight. The pump is fixed with the shock-reducing tightening piece.

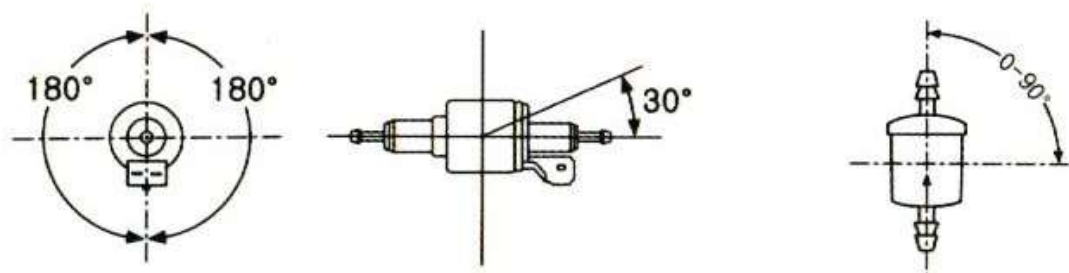

Fuel Filter installation

The fuel filter should be installed before the fuel inlet port. Please make sure that the fuel flow is correctly followed. Its position shall be in conformity with the above picture.

Installation of Fuel Tube

Only the flexible nylon tube, which has good light-resistance and thermal stability, supplied with the heater can be used as the fuel tube. The inner diameter of the tube is $\bar{\bar{I}}$ 2mm.

The position of fuel tube should be against flying stones and be away from any heat emitting parts of the vehicle. Protective device can be installed if necessary.

The fuel tube from the fuel pump to the main heater should be in any directions other than downward direction. The fuel tube shall be tied in some proper location to make it fixed. The distance between two ties shall be less than 50cm.

The fuel tube fittings supplied with the heater should be used for connections between fuel tube and fuel pump, fuel tube and heater, fuel tube and sucking tube of fuel tank and fuel tube and reducing T. The fuel tube should tie with fuel tube clamps. Bubbles should be eliminated from the connecting places.

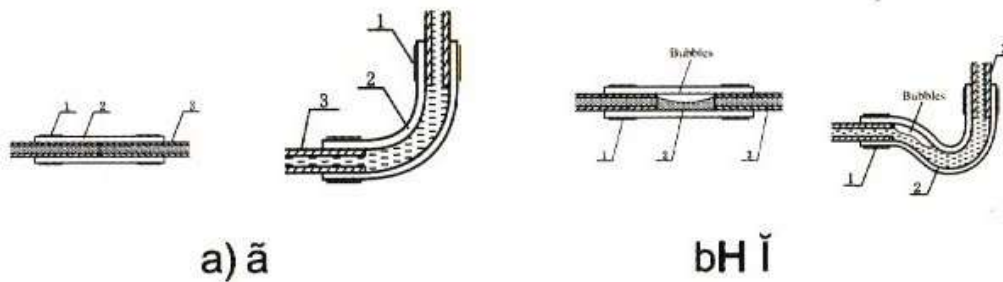

1-Fueltubeclamp;2-Fueltubefitting; 3-Fueltube

Installation of Fuel Taking Device

The openings on the fuel tank (or tank cover)for installation should be appropriate in size,with trimmed brim and with good eveness around the opening.Good sealing is necessary for the base of the fuel taking tube.The bottom end of the fuel taking tubeshouldbe 30mm-40mmfromthe bottom of fuel tank to suck enough fuel and at the same time to avoid sucking in impurities sediment on the bottomof fuel tank.

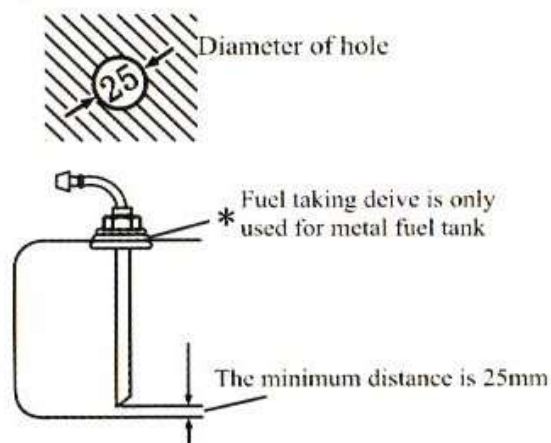

If fuel is taken from the fuel pipe to the engine,the fuel pipe from the fuel tank to the fuel filter shouldbe disconnected

and re-connected with the thicker pipes of the reducing T. And the thinner pipe of the reducing T should connect the fuel pump of the heater via fuel tube fitting and tube. The angle of installation must in conformity with following picture, or normal work of the heater will be affected.

After installation, the vehicle engine shall be started and then turned off after one minute's work to eliminate air trapped in the fuel sucking pipe.

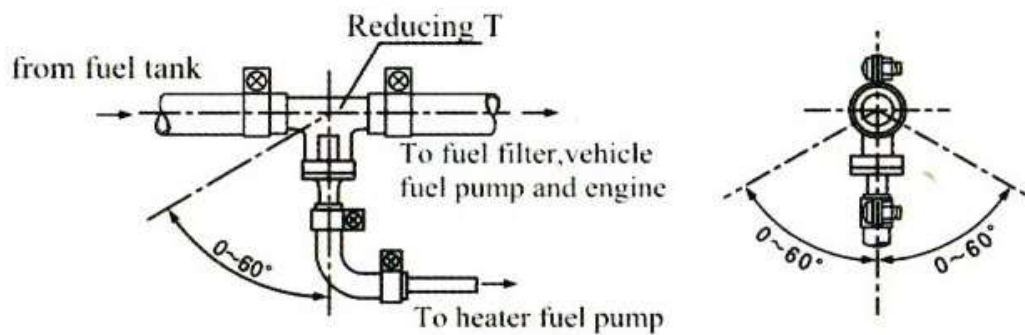

Installation of Electrical System

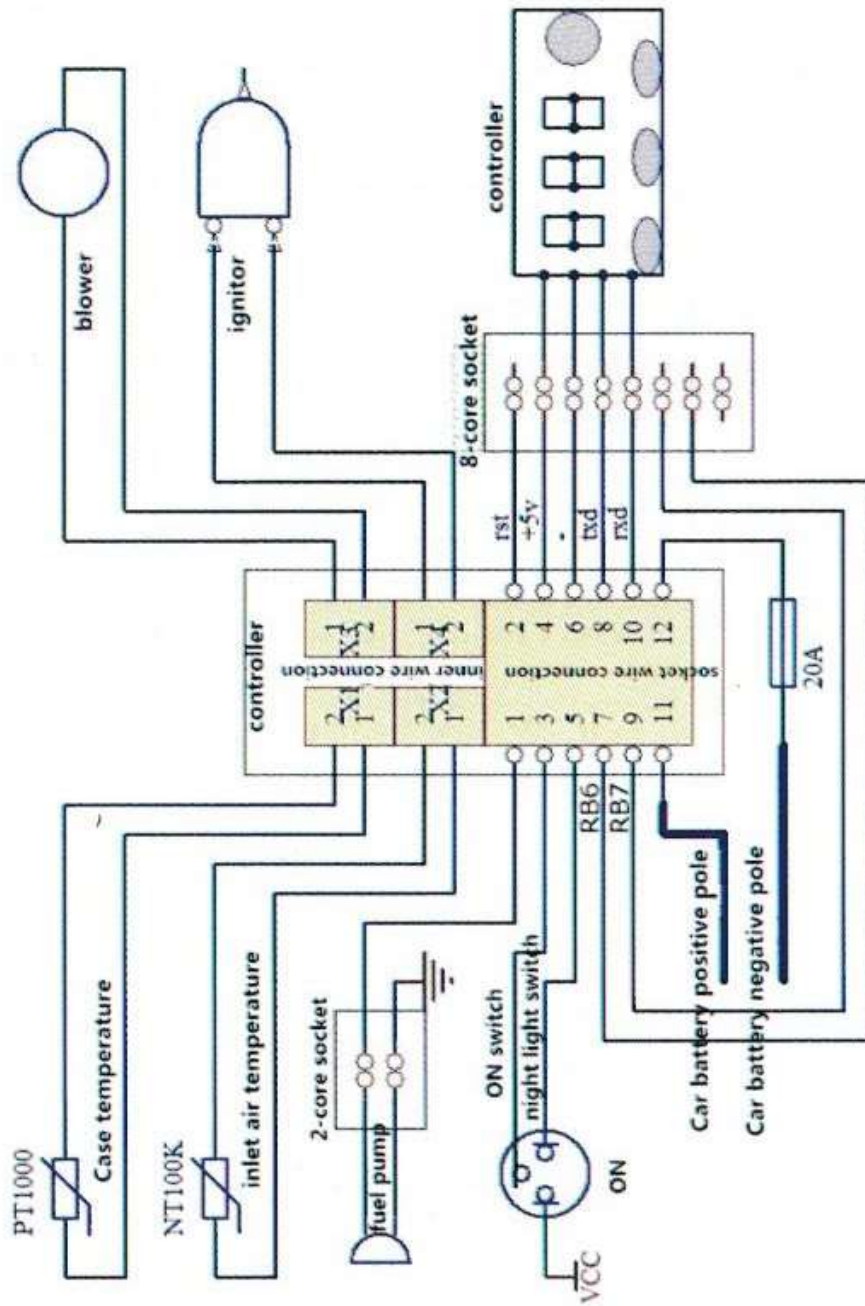

Installation of Combustion Supporting Air Sucking Tube and Exhaust Discharge Tube

The combustion supporting air must be sucked in from external fresh air outside the vehicle. The exhaust from combustion must be discharged into the air through exhaust tube. Measures must be taken to avoid the exhaust from re-entering the vehicle.

The tubes go through the outer wall or holes on the bottom of vehicle. Measures must be taken to prevent entering of splashwater. The tubes must be protected and can resist shock permanently.

Only the air inlet tube and exhaust tube provided with the heater can be used. The air inlet tube is a corrugated pipe made of an aluminum tube that its surface is covered by plastic and paper. The exhaust tube is a corrugated stainless steel tube. Please identify them and do not make mistakes in installation. To connect them with heater, please use the supplied clamp to fix them tightly on the combustion supporting air inlet and exhaust tube vent respectively. The protective hood on the vents of the air inlet tube and exhaust tube must be kept in good condition. Do not damage them or remove them.

Both the air inlet tube and the exhaust tube should come outwards and downwards from the heater, otherwise a \varnothing 4mm hole shall be prepared at the bottom of the tube for discharge of condensation water. If the tube needs a curve, the radius cannot be

smaller than 50mm. Also, the sum of all curve angles for each tube shall not exceed 270°.



The opening of the tubes should not be opposite to the direction of the running vehicle.

The tube openings should not be blocked by slurry, rain and snow or other dirt.

The exhaust tube should be installed in far distance from the plastic parts or other objects with poor thermal resistance of the vehicle body. The exhaust tube should be properly fixed. The exhaust vent should be downwards, perpendicular to road surface with angle of $90^\circ \pm 10^\circ$. To ensure such an angle, the fixing clip for the exhaust tube should be within 150mm from the tube end.

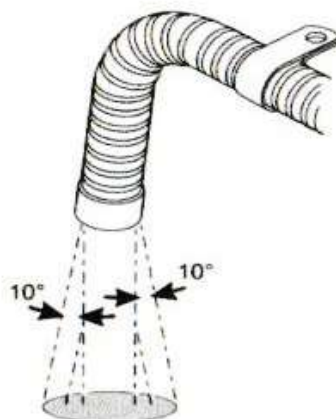

Warning: Violation against the above requirements may cause fire.

If the section of the exhaust tube inside the vehicle may be touched by passenger, a protective cover has to be installed to prevent human contact and scald.

Operation and Control

After the installation, the heater shall be turned on repeatedly for a few times to make the fuel tube full-filled, so as to avoid starting failure due to lacking fuel.

Controller

Rotary Knob Panel Instructions

Introduction of keys:

ON->startup

OFF-> shutdown

Rotary knob->temperature adjustment and wind speed control

Lighting instructions:

Considering that there is lighting below the ON/OFF key, the operators will find out the rotary knob easily under the dark environment. The lighting on the outside of rotary knob will show the temperature value and failure state.

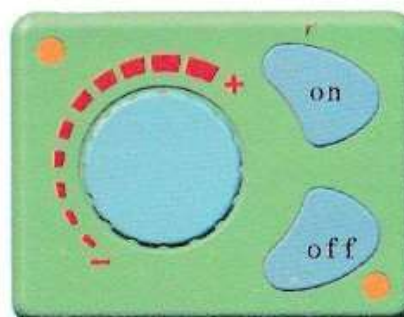

Key function introduction

ON->Please press the ON key gently when the working voltage has satisfied the related conditions.

OFF-> Please press the OFF key gently when the machine is under the working state.

Rotary knob->the temperature will rise when the rotary knob is rotated clockwise, at this moment, the red indicators will be increased on the outside of the rotary knob.

The temperature will down when the rotary knob is rotated anti-clockwise, at this moment, the red indicators will be reduced on the outside of the rotary knob.

Fuel filling by hands

Please rotate the rotary knob clockwise under the OFF state until the red indicators are on, then, please press the OFF button for more than 3 seconds, at this moment, the manual oil pumping will be started. Please press the OFF

Tips:

seconds.

- 1) .The fuel pipe should be 1.5 meter - 2 meters.
- 2). The voltage would be better, if 11.5 V - 12.8 volts.

Installing picture:



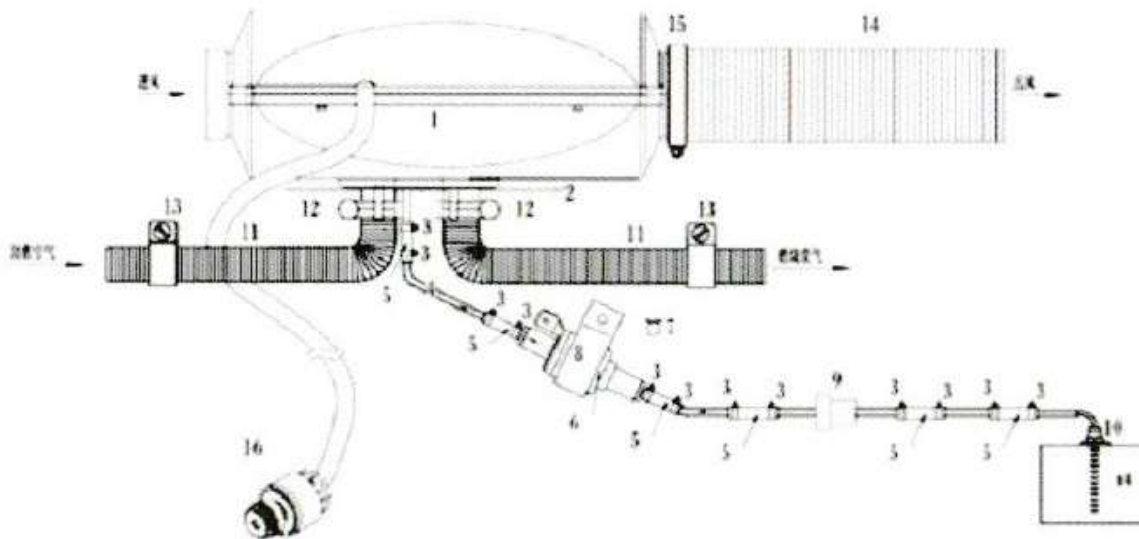

Maintenance

During the running of heater, it tests and checks the operating state and fault in the whole course, and the controller shows fault codes on the LCD / LED constantly.

The fault code of LCD screen

Fault state description

Machine fault	State display	Treatment method
Under-voltage of power supply	1 indicator flickers.	Boost the voltage of power supply.
Overvoltage of power supply	2 indicators flicker.	Reduce the voltage of power supply
The ignition plug is out of order.	3 indicators flicker.	Check whether the ignition plug has suffered from open circuit or short circuit.
Oil pump fault	4 indicators flicker.	Check whether the oil pump has suffered from broken line or short circuit.
The machine is overheating.	5 indicators flicker.	Check the temperature sensor on the shell or whether the fan has the abnormal rotation speed.
Motor fault	6 indicators flicker.	Check the magnet polarity, the Hall sensor location or the looseness conditions of wiring terminal.
Break line fault	7 indicators flicker.	Check the connecting plug of panel, and whether the blue harness connection has become flexible or disconnected.
The flame is extinguished.	8 indicators flicker.	Check whether the oil circuit has air or blockage, check whether the temperature sensor on the shell is out of order or whether the connector terminal has become flexible.

Fault Code Description

Machine fault	Status display	Solution
Undervoltage power source	Panel display E-01	Raise the power supply voltage
Overvoltage power source	Panel display E-02	Reduce the power supply voltage
Ignition plug fault	Panel display E-03	Check whether the ignition plug is open-circuit or short-circuit
Oil pump fault	Panel display E-04	Check whether the oil pump is disconnected or short-circuit
Machine overheat	Panel display E-05	Check the temperature sensor on the shell, or check whether the fan revolution speed is abnormal
Motor fault	Panel display E-06	Check the polarity of the magnet and the position of the Hall sensor.

Disconnection fault	Panel display E-07	Check the connecting plug to the panel, and verify whether the connection of the blue communication line is abnormal
Flame extinguishment	Panel display E-08	Check whether the oil line has any air or whether it is obstructed. Check whether the shell temperature sensor is malfunctioning, or whether the contact of the socket terminal is abnormal.

12V-24V Common Digital Panel Operation Instruction

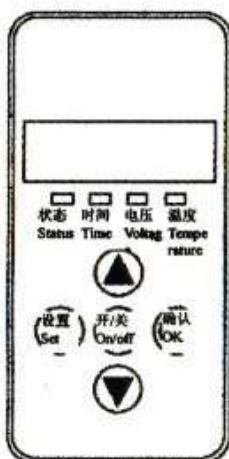

1. Indicators

Status-> Permanently on upon startup, blinking upon the initialization of shutdown, off upon the completion of shutdown

Time-> Permanently on when displaying the time or setting the timed startup or shutdown, and off under other statuses.

Voltage-> Permanently on when displaying voltage or setting the parameters in relation to voltage, and off under other statuses

Temperature-> Permanently on when displaying the ambient temperature or setting the operating temperature, and off under other statuses.

2. Key Function

▲-> Under the setting status, press it to raise the parameter to be set; under the non-setting status, press it to raise the operating temperature to be set

Set-> Enter the setting status to adjust parameters and change the machine's operating status

On/off -> Promptly press it to start up the machine, and the status indicator becomes permanently on; press and hold the key for 2 sec to shut down the machine, and the status indicator becomes blinking

OK-> Under the setting status, press it to confirm the current setting value and proceed to the next parameter to be set; under the non-setting status, press it to view the machine's status

▼-> Under the setting status, press it to reduce the parameter to be set; under the non-setting status, press it to reduce the operating temperature to be set

Description of Setting Parameters (Press the Set Key to Enter)

1. Time setting Use the up/down keys to adjust the parameter → Press the OK key, and consecutively set the Hour (24-hour system) and the Minute, and press the OK key to proceed to the next parameter



2. Timed startup and shutdown setting → It is off by default, displaying 1-OF; press the up arrow key to activate it, displaying 1-on → Press the OK key to consecutively set the first group of startup/shutdown time values and the second group of startup/shutdown time values, and then press the OK key again to proceed to the next parameter



Admin password input → Press the up/down arrow keys, and when the correct value appears, press the OK key to proceed to the next digit. After all four digits are input correctly, press the OK key again to proceed to the next parameter



3. Pump oil volume setting → Press the up/down keys to modify the minimum pump volume, and press the OK key when the required value is set → For the maximum pump oil volume setting, use the up/down arrow keys to modify it as required, and then press the OK key to proceed to the next parameter



4. Fan revolution speed setting → Press the up/down arrow keys to modify the minimum fan revolution speed, and press the OK key when the required value is set → For the maximum fan revolution speed setting, use the up/down arrow keys to modify it as required, and then press the OK key to proceed to the next parameter



5. Operating voltage setting → The main board's operating voltage can only be adjusted under the shutdown status. Press the up/down arrow keys to switch the operating voltage to the 12V system (displaying U-12) or to the 24V system (displaying U-24). (Before startup, please check whether the oil pump, the motor and the ignition plug are suitable to each other, to avoid damage)



6. Revolution speed signal selection

Press the up/down arrow keys to set the revolution speed signal. Select 1 if the vane wheel has two magnets with the opposite polarity or has only one magnet. Please select 2 if the vane wheel has two magnets with the same polarity. If the parameter is incorrect, 1-fold speed error will occur.



7. Admin password modification

By default, the OFF status is displayed. Press the OK key if no modification is needed, to skip the password modification and automatically quit after saving the parameters. Press the up arrow key, and when the ON status is displayed, press the OK key to enter the modification status, and input a 4-digit new password, and press the OK key again to save the new password and the adjusted parameters for automatic quit.

Note: after all parameters are set, you must press the OK key to quit and save the set parameters. If you quit by pressing the Set key, the parameters will not be saved. Please carefully check each digit of the new password, and keep it in mind so that you can use it to change parameters next time.

4. Description of Machine Status Query

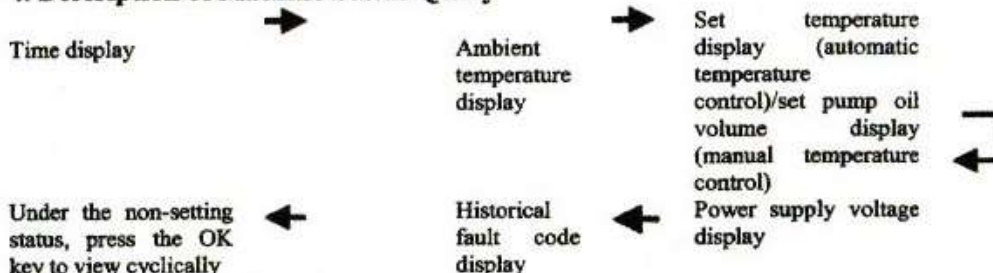

5. Manual Fuel Filling Description

Under the non-setting status, first press and hold the down arrow key, and then press the OK key simultaneously to enter the manual oil pumping interface. When H-OF is displayed, first release the OK key, and then release the down arrow key. Press the up arrow key to activate manual oil pumping, H-ON will be displayed and you will hear the oil pumping noise. Simply press the down arrow key or the Set key to deactivate it and quit the manual oil pumping.

6. Timed Startup/Shutdown Description

After setting the run time, press the OK key to enter the timed startup/shutdown setting function. By default, OF indicates the off status, and please press the up arrow key to activate the ON status, then you can press the OK key to set the first group of values, with the hour and minute values for the startup to be set first, and secondly enter and set the hour and minute values for the shutdown if the values for the startup are set. Then, press the OK key to enter the second group of values, with similar setting measures as those of the first group. You may specify an interval between the two groups of values. The timing function can only be performed once upon each setting, i.e. if the set timing values are performed, they will be invalid, and you need to reactivate the timing function and set new values for the timing.

7. Temperature Control Mode Switchover Description

Under the non-setting status, first press and hold the up arrow key, and then press the Set key

simultaneously, if the panel displays P-xx (xx indicates pump oil volume), it indicates that you have entered the manual temperature control mode and the pump oil volume for operation is restrained within a range between the current pump oil volume and the initial pump oil volume. When you press the above mentioned keys simultaneously and the panel displays xx °C (xx indicates temperature value), it indicates that you have entered the automatic temperature control mode and the pump oil volume for operation is restrained within a range between the maximum pump oil volume and the initial pump oil volume. Under the two modes, the automatic changes of pump oil volume both depend on the variation of the temperature, but the difference between the two modes is that, under the automatic mode, the pump oil volume can reach the maximum value set for the parameter, which leads to higher temperature of the machine; under the manual mode, the pump oil volume is limited to the current setting value and can not reach the maximum value set for the parameter, thus the equipment's temperature is limited to the selected range, which is more adaptable to certain old-fashioned drivers.

8. The instructions on the LCD panel

In the condition of not setting, press raised first, press the confirmation key at the same time, to keep more than 3 seconds. Remote control to the code into the interface, display HFA -, press on the remote control to open fire away

Control code, the code after the exit of code interface, the machine into the boot state, if the code does not enter the boot failure state. Timeout is wrong code automatically withdraw from code.



LCD panel using the above method

Strive for the Perfect Vehicle Life

Xinmaizhong will serve you wholeheartedly

 <p>Warnings</p>	<ol style="list-style-type: none"> 1. The fixed backboard shall be sealed and separated from the vehicle sheet metal during installation to avoid the physical injury to the driver when the combustion gas flows in the driving cab from the gap. 2. The exhaust pipe length shall be 30cm at least. 3. The exhaust gas outlet shall be firmly placed in the empty space. 4. The exhaust pipe outlet shall not look at the driving direction.
<p>Recommendations: It is suggested to apply the sealant to block off the installation gap when the heater has been fixed.</p>	

12V-24V LCD display manual



1. Function

- ◀ -> Setting state, increase the data; If not, increase Hz/°C.
 - -> Press 1 "on", Press 3 "off"
 - ▶ -> Setting state, decrease the data; If not, decrease Hz/°C
- The basic operation uses the above, and the settings uses the following operation:
- Setting->Enter Setting state, adjust data, change working status.
 - -> Setting state, confirm the current data, and enter the next data to set; if not,

2. Check the Setting state (Pres OK: Each time press to switch next state.)

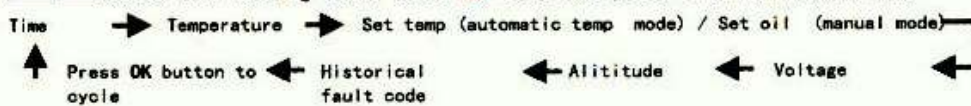

3 Manual fueling description:

In the off state, press and hold ▶ and OK to enter the manual fueling. -Off.
 After releasing, press ◀ to start the operation. You can hear the working sound of the pump and the pump icon lights up. Press ▶ to exit the fuel fill and the pump icon disappears.
 The process of emptying air from the pipeline needs to be observed. When the oil reaches the position of the oil inlet of the machine, it can stop. Excessive fuel enters the machine and there will be black smoke.

4 . The switching description of Temperature control mode:

Press and hold the up ◀ and set keys ■ at the same time to switch the temperature control mode, manual temperature control , automatic temperature control
 The difference between the two temperature control methods is that the automatic mode pump oil can reach the maximum value of the parameter setting, the machine heat is higher, the manual mode pump oil quantity is limited to the current set value, and the parameter setting maximum oil quantity value will not be reached.

5. The match of Remote control and LCD:

On the "off" state. First, press the "power" and "confirm" button simultaneously on Remote controller until LCD screen displaying "wait for matching". Second, press "off" and "on" button on the LCD screen for 3-5 seconds, then the screen will enter the "matching" interface. After match, it will exit automatically and display the normal working parameters. Any match failure, no displaying about the normal working parameters. Overtime fail to match, exit the "matching" interface automatically also.

6. Parameter setting description (press the setting button to enter the setting state)

1. time setting — Press the on or off button to adjust the parameters — Set the hour (24 hour system), minute and other parameters, press the confirm button, then enter to the next interface.
2. Timing power-on Setting — Default off, display off, press on button then show the off, press confirm button— Set hours and minutes in turn, timing by countdown, Max be 99 minutes and 59 seconds.
3. Timing power-off Setting — Default off, display off, press on button then show the off, press confirm button— Set hours and minutes in turn, timing by countdown, Max be 99 minutes and 59 seconds.
4. Input manage passport — Press the "on" or "off" button until it reach the correct value, then press the confirm button enter next interface, Any input error, it will come back to the first digit, then no need to modify subsequent data, press the set button until exit, or wait for 10 seconds for exiting automatically.
5. Pump oil flow setting— Press the "on" or "off" button to adjust minimum pumping oil flow, after reach the value, press confirm button to set the max oil flow— Press the "on" or "off" button to adjust maximum pumping oil flow, after reach the value, press confirm button to enter next interface.
6. Fan speed setting— Press the "on" or "off" button to adjust min speed, after reach the value, press confirm button to set the max speed. Press the "on" or "off" button to adjust max speed, after reach the value, press confirm button to enter next interface.
7. Ignition plug power selection

—————motherboard operating voltage can be only selected under "off" state! Press the "on" or "off"

button to switch--Set the working voltage, adjust the 12V system to display V-12, adjust the 24V system to display V-24, finish select. Please check the match status of oil pump, motor and ignition plug before turn-on.

-----Display 5N-1, Press the "on" or "off" button to set the speed signal, same polarity for 2 magnets on impeller, select 5N-2, different polarity for 2 magnets on impeller or only 1 magnet (Defaults), select 5n-1. Any error for this parameters, 1 times difference for the speed will lead to!

8. Ignition plug power selection, display RF-5, press the "on" or "off" button, modify the value (1=35W, 2=40W, 3=45W, 4=80W, 5=85W, 6=90W) Default value kindly recommend use the default value or modify the value after verification.

9. manage password modification--Initial display off status, no need to change, press confirm button to skip the password modification, and save above modified parameters. Press the on button when modifying. Display on status, press to confirm and enter the password modification status, press the on or off button to adjust. After the 4-digit password is entered correctly, press confirm button to enter next interface. After saving the new password and adjusting the setting parameters, it will exit automatically.



CERTIFICATE

CERTIFICATE OF TECHNICAL INSPECTION

The company named above was audited by UDEM.

Company Name : **Renju Xinmai Zhong Automobile Parts Co., Ltd.**

Company Address : **Liang Zhao Zhen Da Jiang Cun, Renju City, Cangzhou City, Hebei Province, China**

Related Standards : **EN 13842:2004**

Product Name : **Fuel Heater**

Report No and Date : **ESC-RQXM-201808-11A**

Product Brand/Model/Type : **XMZ-D1, XMZ-D2**

Certificate Number : **M.2018.201.N6048**

Initial Assessment Date : **09.08.2018**

Registration Date : **10.08.2018**

Reissue Date/No : **-**

Expiry Date : **09.08.2023**

UDEM International Certification
Auditing Training Centre Industry
and Trade Inc.Co.

The validity of the certificate can be checked through www.udemtd.com.tr. The CE mark can only be used under the responsibility of the manufacturer with the completion of EC Declaration of Conformity for all the relevant Directives. This certificate remains the property of UDEM International Certification Auditing Training Centre Industry and Trade Co. Ltd. to whom it must be returned upon request. The above named firm must keep a copy of this certificate for 13 years from the registration of certificate. This certificate of only covers the product(s) stated above and UDEM must be notified in case of any changes on the product(s).
Address: Mulu Kent Mahallesi 2073 Sokak (Eski 93 Sokak) No:10 Çankaya - Ankara - TURKEY
Phone: +90 0312 443 03 90 Fax: +90 0312 443 03 76
E-mail: info@udemtd.com.tr www.udem.com.tr



Europa Credit Evaluation CERTIFICATE

No. ECU-XMZ-18-08-16A

After the assessment:

Renqiu Xinmai Zhong Automobile parts Co., Ltd.

Liang Zhao Zhen Da Jiang Cun, Renqiu City, Cangzhou City, Hebei Province

Assess compliance with the terms of the Convention on International

Credit guarantee credit rating: **AAA**

- A: Good profitability structure intact, with prospects
- A: Tax law to prove integrity, financial condition
- A: Have the ability to repay debt

Conclusion: EUROPE CREDIT EVALUATION ASSOCIATION has forensic authenticity and validity of corporate legal qualification, and their situation of business and financial condition, potential of developing product (services) to assess the quality and safety inspection.

Date of issue: 16 Aug 2018

Expiry Date: 15 Aug 2020

GENERAL MANAGER



EUROPE CREDIT EVALUATION ASSOCIATION
34 WARDOUR STREET LONDON W1D 6QS UNITED KINGDOM

Tel: +440 2082425518 Fax: +440 207278555

Web: www.ecu-evaluation.org.uk