

ALL RIGHTS RESERVED. REPRODUCTION IN WHOLE OR IN PART IS PROHIBITED WITHOUT THE WRITTEN CONSENT OF THE COPYRIGHT OWNER.

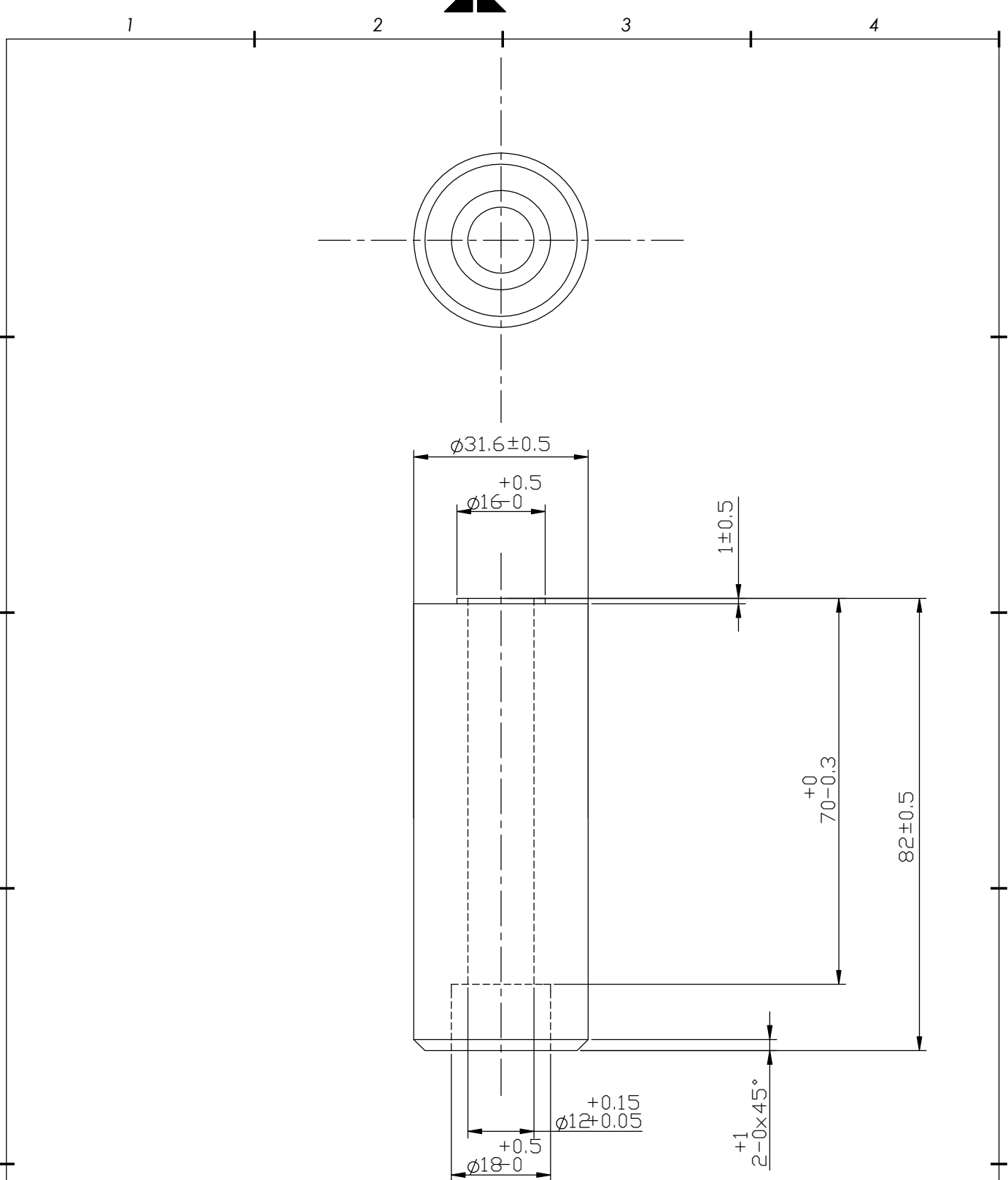

FIRST ANGLE PROJECTION (EUROPEAN)

MATERIAL NUMBER	POM ZWART
SURFACE / HEAT / AFTER TREATMENT	

TOLERANCE ON DECIMALS (UNLESS OTHERWISE SPECIFIED)	,X = ±0,05 X = ±0,25 ,XX = ±0,005
TOLERANCES ON ANGLES (UNLESS OTHERWISE SPECIFIED)	,X ° = ±0,05° X ° = ±0,25° ,XX ° = ±0,005°
SURFACE ROUGHNESS (Ra) (UNLESS OTHERWISE SPECIFIED) (UNITS: μm)	3.2 √

FOR DRAWING INTERPRETATION	TPD 00 0000
SCALE	1:1
UNITS	mm

GREEP